

Cello with VRA package

PRODUCT INSIGHTS

Cello is a PC-based diagnostic audiometer, offering an optional package for performing the pure tone audiometry test on the youngest patients through the two most common approaches: **Visual Reinforcement Audiometry (VRA)** and **Conditioned Play Audiometry (CPA)**. The image below shows the software Pediatric Audiometry test window.

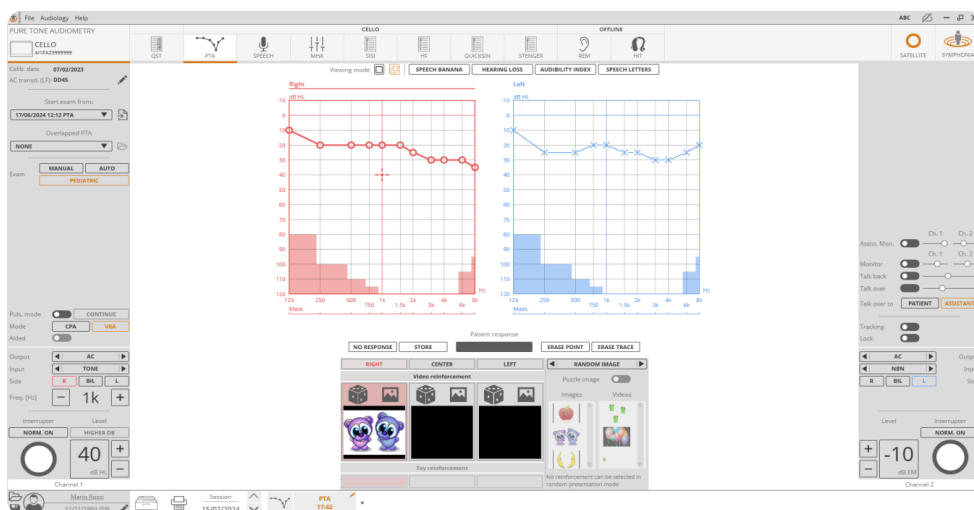

This system enables precise pure tone audiometry while providing seamless control over the reinforcement stimuli. The reinforcements, which include LCD displays showing engaging images or animated toys, are directly integrated with the device. Additionally, the use of the assistant monitor, which can be activated via software, significantly enhances the overall efficiency and accuracy of the testing process.

REINFORCEMENT

Cello offers two types of reinforcement options for young patients: **LCD displays and animated toys**. The system is designed to provide seamless integration and control of these reinforcements, ensuring an engaging and effective testing experience.

- Real-time audiogram display with the “Monitor” function
- Selection of reinforcement from the options: “Monitors”, “Toys”, or “Monitor and Toys”
- Control of the child’s responses via a webcam

The system offers versatile reinforcement configurations, allowing the use of one, two, or three LCD displays dedicated to visual reinforcement, in addition to a separate display for the operator.

If only one display is needed for the patient, the system can be used with almost any computer—either a notebook or a PC—requiring just an additional video output.

However, if you opt for two or three displays as reinforcement, an additional video card is required. This setup necessitates a desktop PC with multiple video outputs, as it is incompatible with notebooks.

Inventis offers pre-configured computers with four video outputs to support this configuration.

In addition to LCD displays, Cello allows the use of animated toys as reinforcement, either in conjunction with or as an alternative to the displays. The toys, selectable between two different options, are directly interfaced with Cello through dedicated outputs on the back panel.



ASSISTANT MONITOR

Using the Assistant Monitor, a second operator can collaborate seamlessly with the primary operator during testing procedures. This feature enables the second operator to audibly monitor the stimuli being delivered to the patient and engage in real-time communication with the primary operator conducting the examination. Simply connect the Assistant Monitor to the back panel of Cello and activate it through the software interface. This collaborative setup significantly enhances the overall efficiency and precision of the testing process.

MAESTRO CONTROL PANEL

Maestro Control Panel is a physical keyboard intended to navigate and control Maestro software, especially (but not only) when performing audiometric exams. The keyboard features dedicated buttons for controlling visual reinforcements and managing the assistant monitor, two key components in pediatric audiometry systems. This allows clinicians to efficiently control these functions not only through the Maestro software interface but also directly from the keyboard, ensuring a more streamlined and intuitive workflow during pediatric testing.

SYSTEM CONFIGURATION

The following image depicts a typical configuration for a complete VRA system with PC-based audiometer **Cello** (ref. code 10558) and the additional **VRA-package** (ref. code 10562).

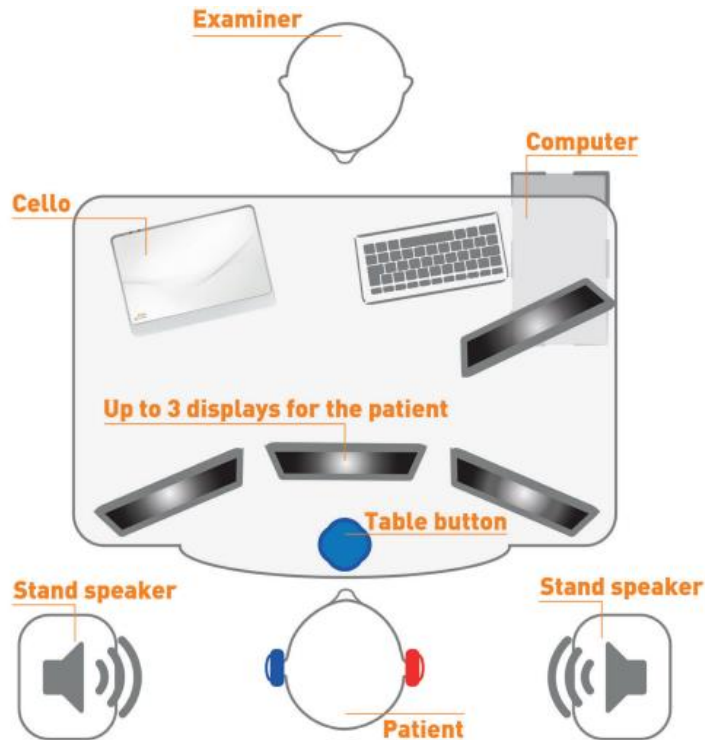

PRODUCT CODES

- 10558: Cello – Computer controlled diagnostic audiometer

INCLUDED PARTS

- DD-45 or TDH-39 supra-aural headphones
- B71 bone vibrator
- Patient response switch
- Monitor headset with boom microphone
- Clip-on microphone for patient-to-operator communication
- Medical grade power supply
- USB connection cable
- User manual
- Inventis software suite

OPTIONAL EXTENSION LICENSES AND PACKAGES (WITH ORDER CODE)

- 10562: Pediatric audiometry (VRA) extension package for Cello. Includes the license code, the desktop switch and the assistant monitor headphones
- 12259: Pediatric audiometry (VRA) license for Cello

OPTIONAL PARTS ONLY FOR CELLO WITH VRA EXTENSIONS (WITH ORDER CODE)

- 10302: Visual Reinforcement for pediatric audiometry – Toy Type 1
- 10303: Visual Reinforcement for pediatric audiometry – Toy Type 2
- 10053: Dedicated table for pediatric audiometry systems
- 10307: Stand for toy and speaker
- 10308: Pre-configured mini-tower computer with 4 video outputs - includes the webcam



INVENTIS S.r.l.
CORSO STATI UNITI, 1/3
35127 PADOVA - ITALIA
TEL: +39 049.8962 844
FAX: +39.049.8966 343
Info@inventis.it
www.inventis.it